

Soils Map

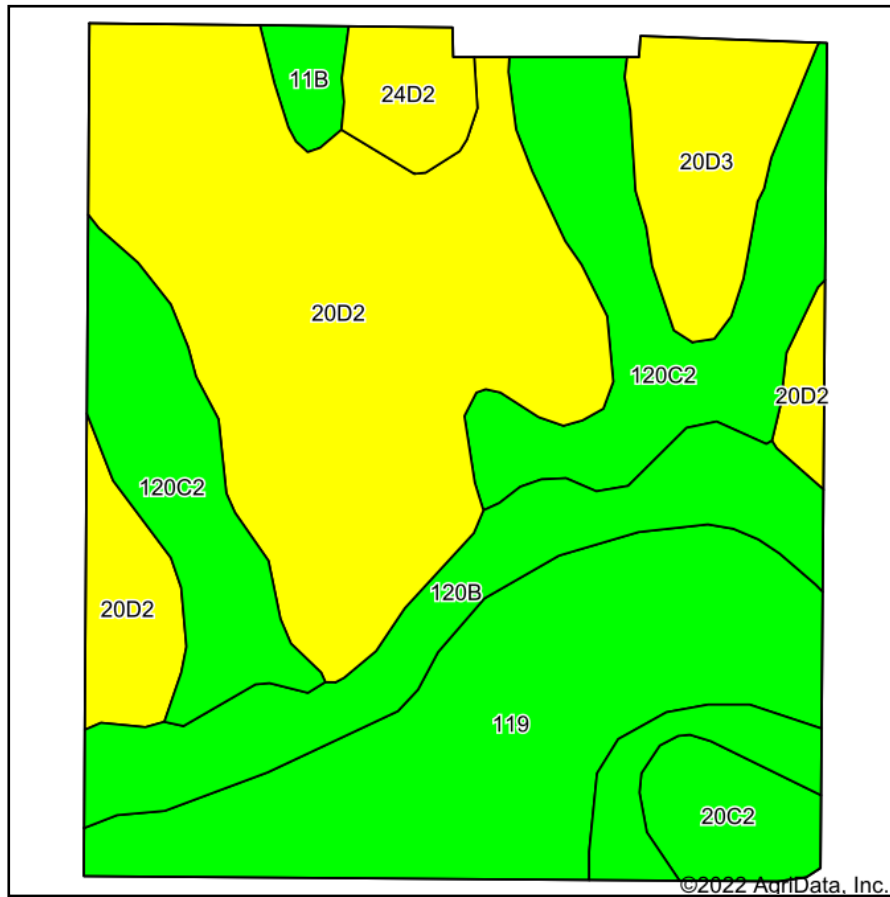

Soils data provided by USDA and NRCS.

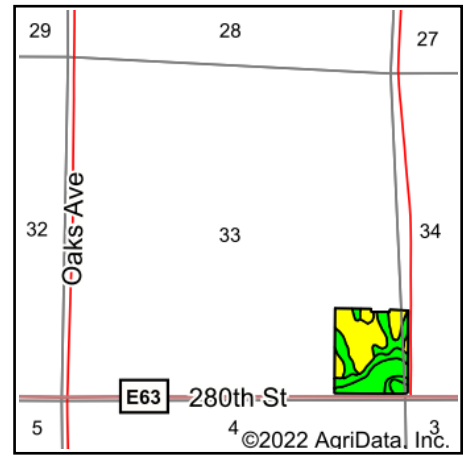

State: **Iowa**
 County: **Marshall**
 Location: **33-83N-18W**
 Township: **Timber Creek**
 Acres: **33.32**
 Date: **9/29/2022**



Maps Provided By:



© AgriData, Inc. 2021

www.AgriDataInc.com



Area Symbol: IA127, Soil Area Version: 26

Code	Soil Description	Acres	Percent of field	CSR2 Legend	Non-Irr Class *c	CSR2**	CSR
20D2	Killduff silty clay loam, 9 to 14 percent slopes, eroded	11.63	34.9%		IIIe	55	63
119	Muscataine silty clay loam, 0 to 2 percent slopes	6.74	20.2%		Iw	100	100
120C2	Tama silty clay loam, 5 to 9 percent slopes, eroded	6.40	19.2%		IIIe	87	78
120B	Tama silty clay loam, 2 to 5 percent slopes	4.15	12.5%		Ile	95	95
20D3	Killduff silty clay loam, 9 to 14 percent slopes, severely eroded	1.99	6.0%		IVe	51	60
20C2	Killduff silty clay loam, 5 to 9 percent slopes, eroded	1.11	3.3%		IIIe	81	73
24D2	Shelby loam, 9 to 14 percent slopes, moderately eroded	0.87	2.6%		IIIe	48	48
11B	Colo-Ely complex, 0 to 5 percent slopes	0.43	1.3%		IIw	86	68
Weighted Average					2.52	76.1	77.2

**IA has updated the CSR values for each county to CSR2.

*c: Using Capabilities Class Dominant Condition Aggregation Method

Soils data provided by USDA and NRCS.